

# XA330

**NEW UNCOATED GRADE**

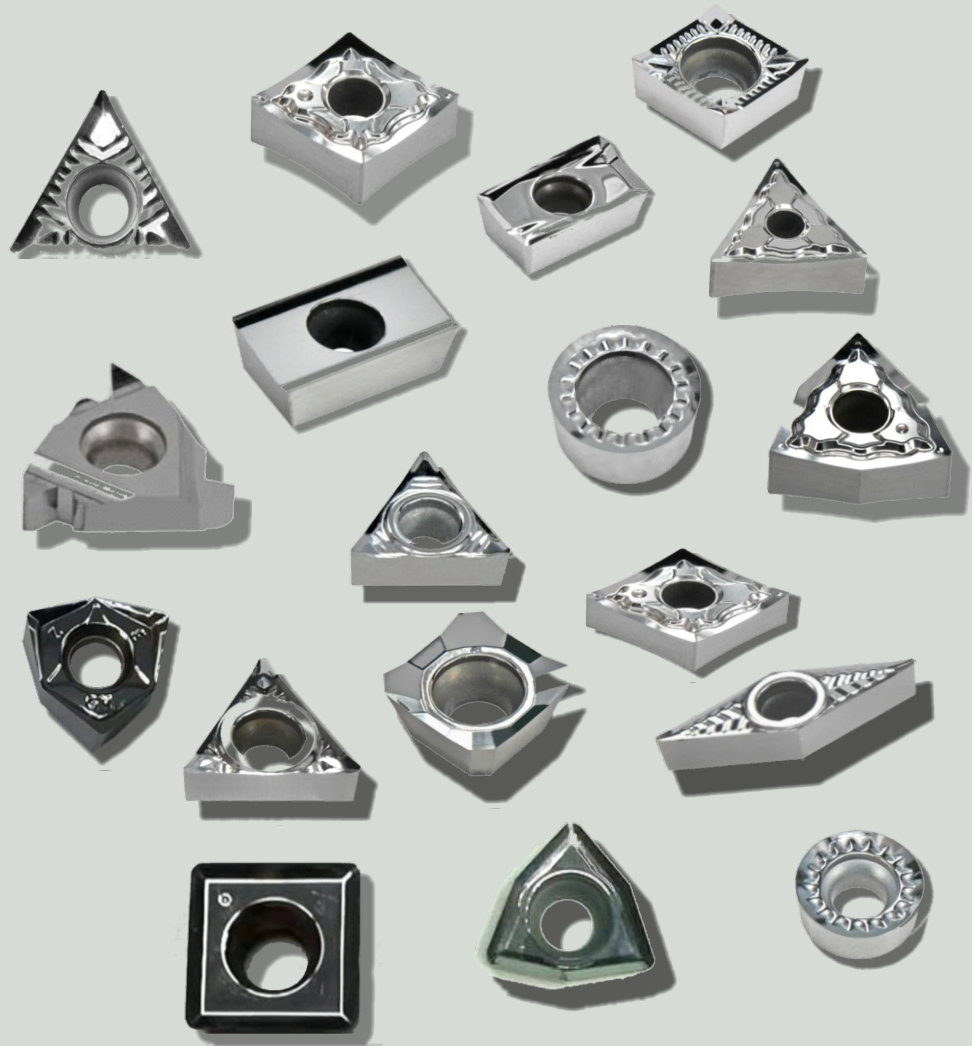

## XA330 Overview

- Superior Carbide Substrate for high performance.
- Uncoated carbide positive and negative inserts capable of fighting any competitor in the market

## Industry Application

- AUTOMOBILE INDUSTRY
- BRASS MACHINING
- SMALL PARTS PRECISION MACHINING
- AEROSPACE INDUSTRY

## Turning Series - Grade XA330 Parameters

Item	Stock	Item	Stock
DCGT070202	0	SCGT09T302	0
DCGT070204	●	SCGT09T304	0
DCGT070208	0	SCGT09T308	0
DCGT11T302	0	SCGT120404	0
DCGT11T304	●	SCGT120408	0
DCGT11T308	●	TCGT090202	0
CCGT060202	●	TCGT090204	●
CCGT060204	●	TCGT110202	0
CCGT060208	●	TCGT110204	●
CCGT09T302	●	TCGT110208	0
CCGT09T304	●	TCGT16T302	0
CCGT09T308	●	TCGT16T304	●
CCGT120402	0	TCGT16T308	●
CCGT120404	●	TNMG160402	0
CCGT120408	●	TNMG160404-HA	●
VBGT110302	0	TNMG160408-HA	●
VBGT110304	●	CNMG120402-HA	0
VBGT110308	0	CNMG120404-HA	●
VBGT160402	0	CNMG120408-HA	●
VBGT160404	●	WNMG080402-HA	0
VBGT160408	●	WNMG080404-HA	0
VCGT110302	0	WNMG080408-HA	●
VCGT110304	●	VNMG160402-HA	0
VCGT110308	0	VNMG160404-HA	●
VCGT160402	0	VNMG160408-HA	●
VCGT160404	●	SNMG120404-HA	0
VCGT160408	●	SNMG120408-HA	0
VCGT160412	0		

● = Stockable / 0 = Non Stockable

Material	Grade	Recommended Cutting Speed
Aluminium	XA330	100 - 250

## Grooving - Grade XA330

Item	Stock
MGGN150-G	0
MGGN200-G	●
MGGN250-G	0
MGGN300-M	●
MGGN400-M	●
MGGN500-M	0

\* Compatible to XGM

## Threading - Grade XA330

Item	Stock
16ER AG55	0
16ER AG60	0
16ER 1.00ISO	0
16ER 1.50ISO	0
16ER 2.00ISO	0
16ER 2.50ISO	0
16ER 3.00ISO	0
16IR AG55	0
16IR AG60	0
16IR 1.00ISO	0
16IR 1.50ISO	0
16IR 2.00ISO	0
16IR 2.50ISO	0
16IR 3.00ISO	0

● = Stockable / 0 = Non Stockable

## Drilling - Grade XA330

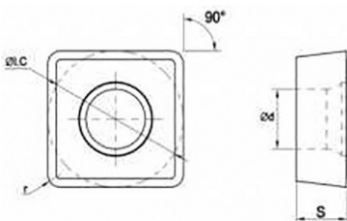

4 Corner Drilling Insert.  
Same Insert For Center And Periphery

Description	L	S	r	d	Feed (mm/tooth)		XA330
					MIN	MAX	
SPGG050204	5	2.38	0.4	2.25	0.04	0.12	●
SPGG060204	6	2.38	0.4	2.61	0.04	0.12	●
SPGG07T308	7.94	3.97	0.05	2.85	0.05	0.15	●
SPGG090408	9.8	4.3	0.06	4.05	0.06	0.15	●
SPGG110408	11.5	4.8	0.06	4.45	0.06	0.18	●
SPGG140512	14.3	5.2	0.08	5.75	0.08	0.2	●

● = Stockable / 0 = Non Stockable

## Drilling - Grade XA330

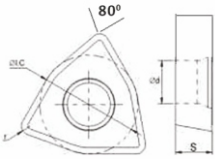

3 Corner Drilling Insert.  
Same Insert For Center And Periphery

Description	L	s	d	r	iC	Feed (mm/tooth)		XA330
						MIN	MAX	
WCMX030208	3.4	2.4	2.8	0.8	5.6	0.04	0.09	●
WCMX040208	4.3	2.4	3.1	0.8	6.4	0.04	0.11	●
WCMX050308	5.4	3.2	3.2	0.8	7.9	0.04	0.11	●
WCMX06T308	6.5	4	3.7	0.8	9.5	0.06	0.13	●
WCMX080412	8.7	4.8	4.3	1.2	13	0.08	0.18	●

● = Stockable / ○ = Non Stockable

## Milling - Grade XA330

Face Milling

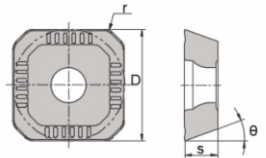

Description	Dimension				Feed (mm/tooth)		Depth of cut		Stock
	di	F	S	R	MIN	MAX	MIN	MAX	
SEHT1204	13.3	11	4.8	-	0.05	0.2	0.2	2	●

● = Stockable / ○ = Non Stockable

Shoulder Milling

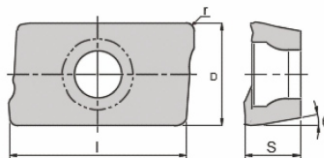

Description	Dimension					Feed (mm/tooth)		Depth of cut		Stock
	I	D	S	∅	R	MIN	MAX	MIN	MAX	
APKT1604PDTR	16.3	9.5	5.3	11	0.8	0.10	0.32	0.50	12	○

● = Stockable / ○ = Non Stockable

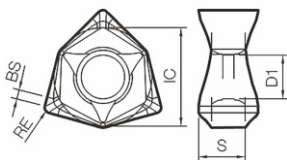

Description	Dimension					Feed (mm/tooth)				Stock
	D1	S	BS	IC	RE	MIN	MAX	MIN	MAX	
WNGX080608- GM	6.2	6.7	1.3	14	0.8	0.08	0.4	0.5	7	●

● = Stockable / ○ = Non Stockable