



## INDEXABLE U DRILL

We have 2 popular types of Indexable U Drills, one with 3 corners and other with 4 corners

The central and peripheral inserts are the same .

U Drill range is from 13mm upto 50mm

INSERT DESIGNATION

**SPMG**

**4 Corner Drilling Insert**  
Same insert for centre and periphery.

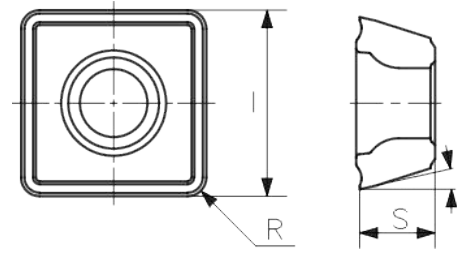

Description	L	S	r	d	FEED(mm/tooth)		XT110	XT125-C	XT830	GM-XT840	GM-XT930C
					MIN	MAX					
SPMG050204	5	2.38	0.4	2.25	0.04	0.12	●	●	●	●	●
SPMG060204	6	2.38	0.4	2.61	0.04	0.12	●	●	●	●	●
SPMG07T308	7.94	3.97	0.8	2.85	0.05	0.15	●	●	●	●	●
SPMG090408	9.8	4.3	0.8	4.05	0.06	0.15	●	●	●	○	●
SPMG110408	11.5	4.8	0.8	4.45	0.06	0.18	●	●	●	○	●
SPMG140512	14.3	5.2	1.2	5.75	0.08	0.20	●	●	●	○	●

● STOCKABLE ○ NON STOCKABLE

INSERT DESIGNATION

**WCMX**

**3 Corner Drilling Insert**  
Same insert for centre periphery

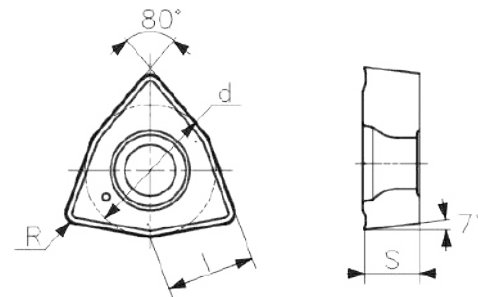

Description	L	S	r	d	iC	FEED(mm/tooth)		XT110	XT830	XT840	XT930-C
						MIN	MAX				
WCMX030208	3.40	2.38	2.80	0.80	5.56	0.04	0.09	●	○	○	●
WCMX040208	4.30	2.38	3.10	0.80	6.35	0.04	0.11	●	○	○	●
WCMX050308	5.40	3.18	3.20	0.80	7.94	0.04	0.11	●	○	○	●
WCMX06T308	6.50	3.97	3.70	0.80	9.53	0.06	0.13	●	○	○	●
WCMX080412	8.70	4.76	4.30	1.20	12.70	0.08	0.18	●	○	○	●

● STOCKABLE ○ NON STOCKABLE

DRILLING

## U-DRILL BODY

## L / D 2 SERIES

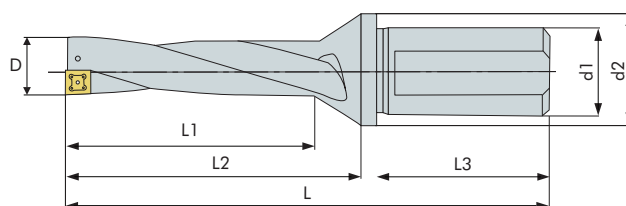

Description	D	1	L1	L2	L3	d1	d2	Insert	Screw	Wrench	Stock
H-MDR2130-20T2-05	13.00	101	31	46	50	20	25	SPMG05	M2.0*5	T-6	○
H-MDR2135-20T2-05	13.50	102	32	47							○
H-MDR2140-20T2-05	14.00	103	33	48							●
H-MDR2145-20T2-05	14.50	104	34	49							●
H-MDR2150-20T2-05	15.00	112	35	50							●
H-MDR2155-25T2-06	15.50	113	36	50	56	25	32	SPMG06	M2.2*5	T-7	●
H-MDR2160-25T2-06	16.00	114	37	51							●
H-MDR2165-25T2-06	16.50	115	38	52							●
H-MDR2170-25T2-06	17.00	116	39	53							●
H-MDR2175-25T2-06	17.50	117	40	54							●
H-MDR2180-25T2-06	18.00	118	41	55							●
H-MDR2185-25T2-06	18.50	119	42	56							●
H-MDR2190-25T2-06	19.00	120	43	57							●
H-MDR2195-25T2-06	19.50	121	44	58							●
H-MDR2200-25T2-06	20.00	122	45	59							○
H-MDR2205-25T2-06	20.50	123	46	60	○						
H-MDR2210-25T2-06	21.00	124	47	61	○						
H-MDR2215-25T2-06	21.50	125	48	62	○						
H-MDR2220-32T2-07	22	126	49	63	60	32	44	SPMG07	M2.5*8	T-8	○
H-MDR2225-32T2-07	22.5	127	50	64							○
H-MDR2230-32T2-07	23	136	51	69							○
H-MDR2235-32T2-07	23.5	137	52	70							○
H-MDR2240-32T2-07	24	138	53	71							○
H-MDR2245-32T2-07	24.5	139	54	72							○
H-MDR2250-32T2-07	25	140	55	73							○
H-MDR2255-32T2-07	25.5	141	56	74							○
H-MDR2260-32T2-07	26	142	57	75							○
H-MDR2265-32T2-07	26.5	143	58	76							○
H-MDR2270-32T2-07	27	144	59	77							○
H-MDR2275-32T2-07	27.5	145	60	78	○						

● STOCKABLE ○ NON STOCKABLE

U-DRILL BODY

L / D 2 SERIES

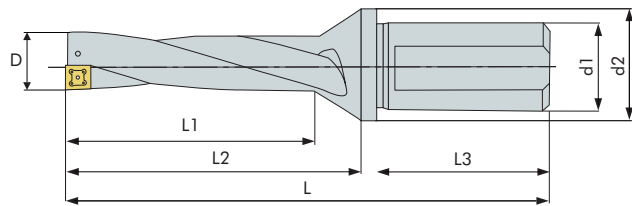

Description	D	L	L1	L2	L3	d1	d2	Insert	Screw	Wrench	Stock
H-MDR2280-32T2-09	28	146	61	79	60	32	44	SPMG09	M3.5*9	T-15	○
H-MDR2285-32T2-09	28.5	147	62	80							○
H-MDR2290-32T2-09	29	148	63	81							○
H-MDR2295-32T2-09	29.5	149	64	82							○
H-MDR2300-32T2-09	30	150	65	83							○
H-MDR2305-32T2-09	30.5	151	66	84							○
H-MDR2310-32T2-09	31	152	67	85							○
H-MDR2315-32T2-09	31.5	153	68	86							○
H-MDR2320-32T2-09	32	154	69	87							○
H-MDR2325-32T2-09	32.5	155	70	88							○
H-MDR2330-32T2-09	33	156	71	89							○
H-MDR2335-32T2-09	33.5	157	72	90							○
H-MDR2340-32T2-11	34	158	73	91	60	32	44	SPMG11	M4.0*10	T-15	○
H-MDR2350-32T2-11	35	159	74	92							○
H-MDR2360-32T2-11	36	160	75	93							○
H-MDR2370-32T2-11	37	161	76	94							○
H-MDR2380-32T2-11	38	162	77	95							○
H-MDR2390-32T2-11	39	163	78	96							○
H-MDR2400-32T2-11	40	164	79	97							○
H-MDR2410-32T2-11	41	165	80	98							○
H-MDR2420-40T2-14	42	166	81	99	70	40	54	SPMG14	M5.0*11	T-20	○
H-MDR2430-40T2-14	43	167	82	100							○
H-MDR2440-40T2-14	44	168	83	101							○
H-MDR2450-40T2-14	45	169	84	102							○
H-MDR2460-40T2-14	46	170	85	103							○
H-MDR2470-40T2-14	47	171	86	101							○
H-MDR2480-40T2-14	48	172	87	102							○
H-MDR2490-40T2-14	49	173	88	103							○
H-MDR2500-40T2-14	50	174	89	104							○

DRILLING

● STOCKABLE ○ NON STOCKABLE

## U-DRILL BODY

## L / D 3 SERIES

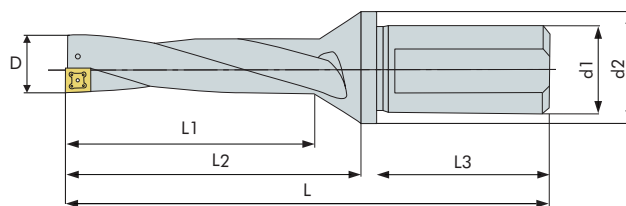

Description	D	L	L1	L2	L3	d1	d2	Insert	Screw	Wrench	Stock
H-MDR3130-20T2-05	13	114	44	59	50	20	25	SPMG05	M2.0*5	T-6	●
H-MDR3135-20T2-05	13.5	115.5	45.5	60.5							●
H-MDR3140-20T2-05	14	117	47	62							●
H-MDR3145-20T2-05	14.5	118.5	48.5	63.5							●
H-MDR3150-20T2-05	15	128	50	65							●
H-MDR3155-25T2-06	15.5	128.5	51.5	65.5	57	25	32	SPMG06	M2.2*5	T-7	●
H-MDR3160-25T2-06	16	130	53	67							●
H-MDR3165-25T2-06	16.5	131.5	54.5	68.5							●
H-MDR3170-25T2-06	17	133	56	70							●
H-MDR3175-25T2-06	17.5	134.5	57.5	71.5							●
H-MDR3180-25T2-06	18	136	59	73							●
H-MDR3185-25T2-06	18.5	137.5	60.5	74.5							●
H-MDR3190-25T2-06	19	139	62	76							●
H-MDR3195-25T2-06	19.5	140.5	63.5	77.5							●
H-MDR3200-25T2-06	20	142	65	79							●
H-MDR3205-25T2-06	20.5	143.5	66.5	80.5	60	32	44	SPMG07	M2.5*8	T-8	●
H-MDR3210-25T2-06	21	145	68	82							●
H-MDR3215-25T2-06	21.5	146.5	69.5	83.5							●
H-MDR3220-32T2-07	22	148	71	85							●
H-MDR3225-32T2-07	22.5	149.5	72.5	86.5							●
H-MDR3230-32T2-07	23	159	74	92							●
H-MDR3235-32T2-07	23.5	160.5	75.5	93.5							●
H-MDR3240-32T2-07	24	162	77	95							●
H-MDR3245-32T2-07	24.5	163.5	78.5	96.5							●
H-MDR3250-32T2-07	25	165	80	98							●
H-MDR3255-32T2-07	25.5	166.5	81.5	99.5							●
H-MDR3260-32T2-07	26	168	83	101							●
H-MDR3265-32T2-07	26.5	169.5	84.5	102.5	●						
H-MDR3270-32T2-07	27	171	86	104	●						
H-MDR3275-32T2-07	27.5	172.5	87.5	105.5	●						

● STOCKABLE ○ NON STOCKABLE

U-DRILL BODY

L / D 3 SERIES

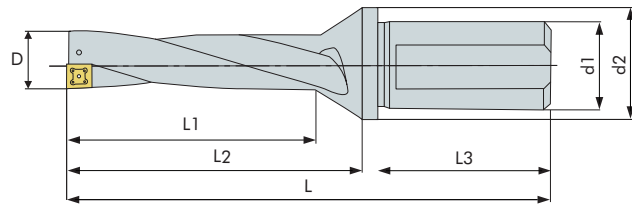

Description	D	L	L1	L2	L3	d1	d2	Insert	Screw	Wrench	Stock
H-MDR3280-32T2-09	28	174	89	107	60	32	44	SPMG09	M3.5*9	T-15	●
H-MDR3285-32T2-09	28.5	175.5	90.5	108.5							●
H-MDR3290-32T2-09	29	177	92	110							●
H-MDR3295-32T2-09	29.5	178.5	93.5	111.5							●
H-MDR3300-32T2-09	30	180	95	113							●
H-MDR3305-32T2-09	30.5	181.5	96.5	114.5							●
H-MDR3310-32T2-09	31	183	98	116							●
H-MDR3315-32T2-09	31.5	184.5	99.5	117.5							●
H-MDR3320-32T2-09	32	186	101	119							●
H-MDR3325-32T2-09	32.5	187.5	102.5	120.5							●
H-MDR3330-32T2-09	33	189	104	122							●
H-MDR3335-32T2-09	33.5	190.5	105.5	123.5							●
H-MDR3340-32T2-11	34	192	107	125	60	32	44	SPMG11	M4.0*10	T-15	●
H-MDR3350-32T2-11	35	195	110	128							●
H-MDR3360-32T2-11	36	198	113	131							○
H-MDR3370-32T2-11	37	201	116	134							○
H-MDR3380-32T2-11	38	204	119	137							○
H-MDR3390-32T2-11	39	207	122	140							○
H-MDR3400-32T2-11	40	210	125	143							○
H-MDR3410-32T2-11	41	218	128	143							○
H-MDR3420-40T2-14	42	221	131	146	70	40	54	SPMG14	M5.0*11	T-20	○
H-MDR3430-40T2-14	43	224	134	149							○
H-MDR3440-40T2-14	44	227	137	152							○
H-MDR3450-40T2-14	45	230	140	155							○
H-MDR3460-40T2-14	46	233	143	158							○
H-MDR3470-40T2-14	47	236	146	161							○
H-MDR3480-40T2-14	48	239	149	164							○
H-MDR3490-40T2-14	49	242	152	167							○
H-MDR3500-40T2-14	50	245	155	170							○

● STOCKABLE ○ NON STOCKABLE

DRILLING

## U-DRILL BODY

## L / D 4 SERIES

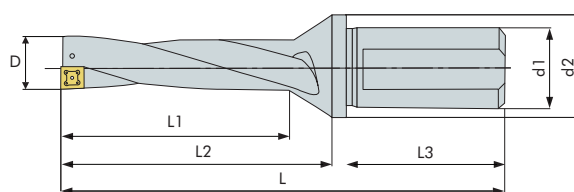

Description	D	L	L1	L2	L3	d1	d2	Insert	Screw	Wrench	Stock
H-MDR4130-20T2-05	13	127	57	72	50	20	25	SPMG05	M2.0*5	T-6	○
H-MDR4135-20T2-05	13.5	129	59	74							○
H-MDR4140-20T2-05	14	131	61	76							○
H-MDR4145-20T2-05	14.5	133	63	78							○
H-MDR4150-20T2-05	15	142	65	80							○
H-MDR4155-25T2-06	15.5	144	67	81	56	25	32	SPMG06	M2.2*5	T-7	●
H-MDR4160-25T2-06	16	146	69	83							●
H-MDR4165-25T2-06	16.5	148	71	85							●
H-MDR4170-25T2-06	17	150	73	87							●
H-MDR4175-25T2-06	17.5	152	75	89							●
H-MDR4180-25T2-06	18	154	77	91							●
H-MDR4185-25T2-06	18.5	156	79	93							●
H-MDR4190-25T2-06	19	158	81	95							●
H-MDR4195-25T2-06	19.5	160	83	97							●
H-MDR4200-25T2-06	20	162	85	99							●
H-MDR4205-25T2-06	20.5	164	87	101	●						
H-MDR4210-25T2-06	21	166	89	103	●						
H-MDR4215-25T2-06	21.5	168	91	105	●						
H-MDR4220-32T2-07	22	170	93	107	60	32	44	SPMG07	M2.5*8	T-8	●
H-MDR4225-32T2-07	22.5	172	95	109							●
H-MDR4230-32T2-07	23	182	97	115							●
H-MDR4235-32T2-07	23.5	184	99	117							●
H-MDR4240-32T2-07	24	186	101	119							●
H-MDR4245-32T2-07	24.5	188	103	121							●
H-MDR4250-32T2-07	25	190	105	123							●
H-MDR4255-32T2-07	25.5	192	107	125							●
H-MDR4260-32T2-07	26	194	109	127							●
H-MDR4265-32T2-07	26.5	196	111	129							●
H-MDR4270-32T2-07	27	198	113	131							●
H-MDR4275-32T2-07	27.5	200	115	133							●

● STOCKABLE ○ NON STOCKABLE

U-DRILL BODY

L / D 4 SERIES

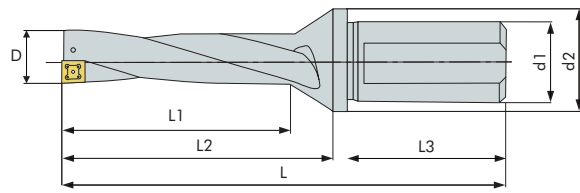

Description	D	L	L1	L2	L3	d1	d2	Insert	Screw	Wrench	Stock
H-MDR4280-32T2-09	28	202	117	135	60	32	44	SPMG09	M3.5*9	T-15	○
H-MDR4285-32T2-09	28.5	204	119	137							○
H-MDR4290-32T2-09	29	206	121	139							○
H-MDR4295-32T2-09	29.5	208	123	141							○
H-MDR4300-32T2-09	30	210	125	143							○
H-MDR4305-32T2-09	30.5	212	127	145							○
H-MDR4310-32T2-09	31	214	129	147							○
H-MDR4315-32T2-09	31.5	216	131	149							○
H-MDR4320-32T2-09	32	218	133	151							○
H-MDR4325-32T2-09	32.5	220	135	153							○
H-MDR4330-32T2-09	33	222	137	155							○
H-MDR4335-32T2-09	33.5	224	139	157							○
H-MDR4340-32T2-11	34	226	141	159	60	32	44	SPMG11	M4.0*10	T-15	○
H-MDR4350-32T2-11	35	228	143	161							○
H-MDR4360-32T2-11	36	230	145	163							○
H-MDR4370-32T2-11	37	232	147	165							○
H-MDR4380-32T2-11	38	234	149	167							○
H-MDR4390-32T2-11	39	236	151	169							○
H-MDR4400-32T2-11	40	238	153	171							○
H-MDR4410-32T2-11	41	240	155	173							○
H-MDR4420-40T2-14	42	242	157	175	70	40	54	SPMG14	M5.0*11	1-20	○
H-MDR4430-40T2-14	43	244	159	177							○
H-MDR4440-40T2-14	44	246	161	179							○
H-MDR4450-40T2-14	45	248	163	181							○
H-MDR4460-40T2-14	46	250	165	183							○
H-MDR4470-40T2-14	47	252	167	185							○
H-MDR4480-40T2-14	48	254	169	187							○
H-MDR4490-40T2-14	49	256	171	189							○
H-MDR4500-40T2-14	50	258	173	191							○

● STOCKABLE ○ NON STOCKABLE

DRILLING